



Helmsman Rise, St. Leonards-On-Sea TN38 8BQ

Offers in excess of £220,000



Attractive TWO BEDROOM end of terraced house set in an EXCLUSIVE development on the outskirts of St. Leonards, towards Battle. The accommodation here is arranged over two floors, with a welcoming entrance hall and a handy downstairs cloakroom. There is a WELL PRESENTED LIVING SPACE with double doors leading out to the rear garden and a MODERN FITTED KITCHEN which enjoys a front aspect. On the first floor are two double bedrooms, both with BUILT IN STORAGE, and a family bathroom. The rear garden has been designed for low maintenance providing a paved area perfect for dining al fresco dining with ascending tiers of artificial lawn. To the front of the property there is an ALLOCATED OFF ROAD PARKING SPACE. Boasting STUNNING COUNTRYSIDE AND SEA VIEWS this fantastic property would make the PERFECT FIRST TIME HOME.

GROUND FLOOR
295 sq.ft. (27.4 sq.m.) approx.

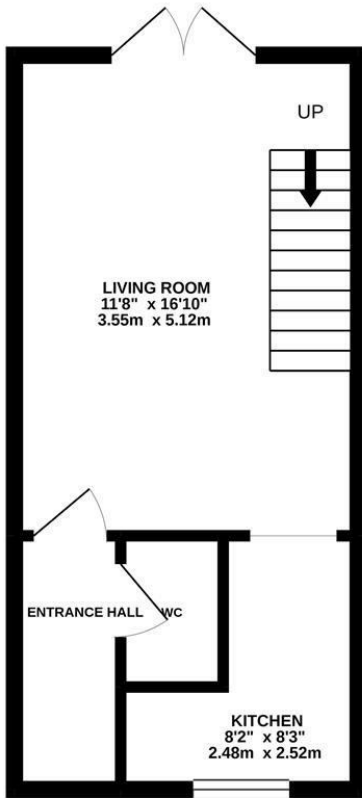

1ST FLOOR
295 sq.ft. (27.4 sq.m.) approx.

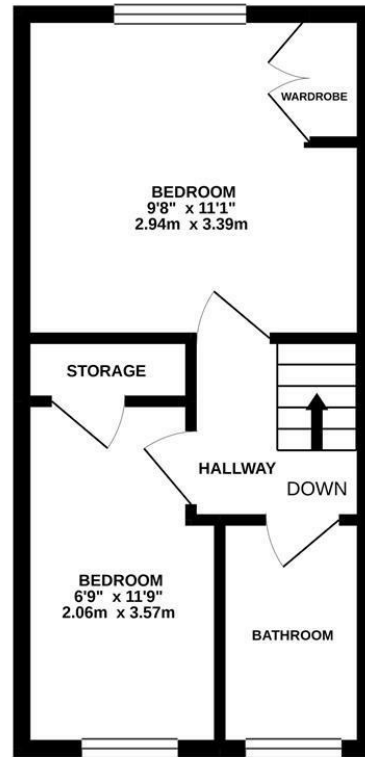

TOTAL FLOOR AREA : 591 sq.ft. (54.9 sq.m.) approx.

Whilst every attempt has been made to ensure the accuracy of the floorplan contained here, measurements of doors, windows, rooms and any other items are approximate and no responsibility is taken for any error, omission or mis-statement. This plan is for illustrative purposes only and should be used as such by any prospective purchaser. The services, systems and appliances shown have not been tested and no guarantee as to their operability or efficiency can be given.
Made with Metropix ©2021

